

NEWMEN

NEWMEN pedal Beskar

Technical Manual

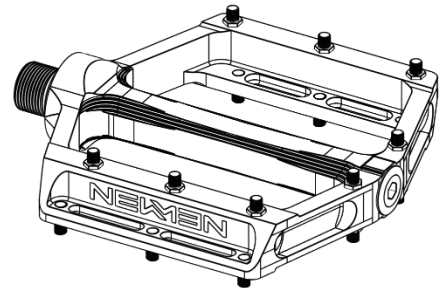
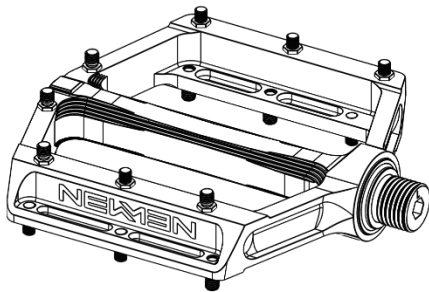

Version: 1.0; Date: 11.09.2024

Content

1	Safety and instructions for use.....	3
2	Warranty and crash replacement.....	4
2.1	Warranty summary.....	4
2.2	Crash Replacement summary.....	4
3	Technical data.....	5
3.1	List of tools.....	5
3.2	General information.....	5
3.3	Installation.....	6
4	Maintenance.....	7
4.1	Pedal maintenance schedule.....	7
4.2	Grease NEWMEN pedal.....	7
4.3	Service the pedal.....	8

1 Safety and instructions for use



DANGER

Not following the below points can cause the components to fail which can cause the rider to lose control resulting in SEVERE INJURY OR DEATH.

Before and after every ride, check to see whether any of the components are damaged and that everything is still intact. If problems arise, the components should no longer be used. If you are in doubt, please see your local bicycle dealer.

- Follow the manufacturer's instructions for installing the components on the bicycle. The user manuals for all NEWMEN products can be found at www.newmen-components.de/Downloads
- Follow the manufacturer's safety instructions
- Follow the maximum system weight as specified in the manufacturer's instructions
- Before every ride you should make sure that all the components are properly tightened.
- The components must be compatible with all parts of the bicycle. If in doubt consult your dealer
- The components are only to be used according to their stated purpose. See the document "classification and intended use" at www.newmen-components.de/Downloads
Only use original replacement parts. Do not change or modify the components.
- All components must be serviced by a specialist dealer according to the maintenance plan in the product manual.
- Do not clean the components with high-pressure power washers.
- If there is any damage or indication of damages, then the components cannot be used without further analysis. If there is any doubt, please contact your local dealer.

MG-Components GmbH & Co KG offer first class service and crash replacement exceeding the legally required warranty. For detailed information please visit www.newmen-components.de

2 Warranty and crash replacement

In addition to high-quality products, we also offer first class service. That is why MG-Components GmbH & Co. KG provides not only the legally required warranty on all NEWMEN products, but also an additional three-year warranty on all material and manufacturing defects.

2.1 Warranty summary

- All components must be installed and used according to the assembly instructions.
- The respective manufacturer's warranty applies to all third-party parts.
- Improper use, not following the instructions for use, incorrect repair, assembly or maintenance are not covered under the warranty.

2.2 Crash Replacement summary

- The offer is valid for three years from the date of purchase.
- It can also be transferred to the next owner.
- Damages must affect functionality (visual damages are excluded).
- Replacement is made with the same model. However, MG-Components GmbH & Co. KG reserves the right to replace the damaged article with an alternative product of the same value.
- You have no legal claim to the damaged product, which will become the property of MG-Components GmbH & Co. KG.
- MG-Components GmbH & Co. KG will not pay for costs related to assembly, shipping or customs.
- Crash Replacement is not a substitute for any warranty stipulations that apply in the individual countries.
- Components such as tyres, cassettes, brake discs, brake callipers, etc. must be removed.
- The following is a list of reasons why the Warranty and the Crash Replacement Service guarantee benefits may not apply.
- Damages caused by incorrect installation of the components.
- Damages caused by incorrect repairs to the components.
- Improper use, e.g. a cross-country wheelset used for downhill riding
- Modification to the components
- Maintenance or repairs that were either incorrectly done or not carried out
- Normal wear and tear from use of the components
- Transport and delivery damages
- Improper use and/or mishandling
- Damages from an accident

3 Technical data

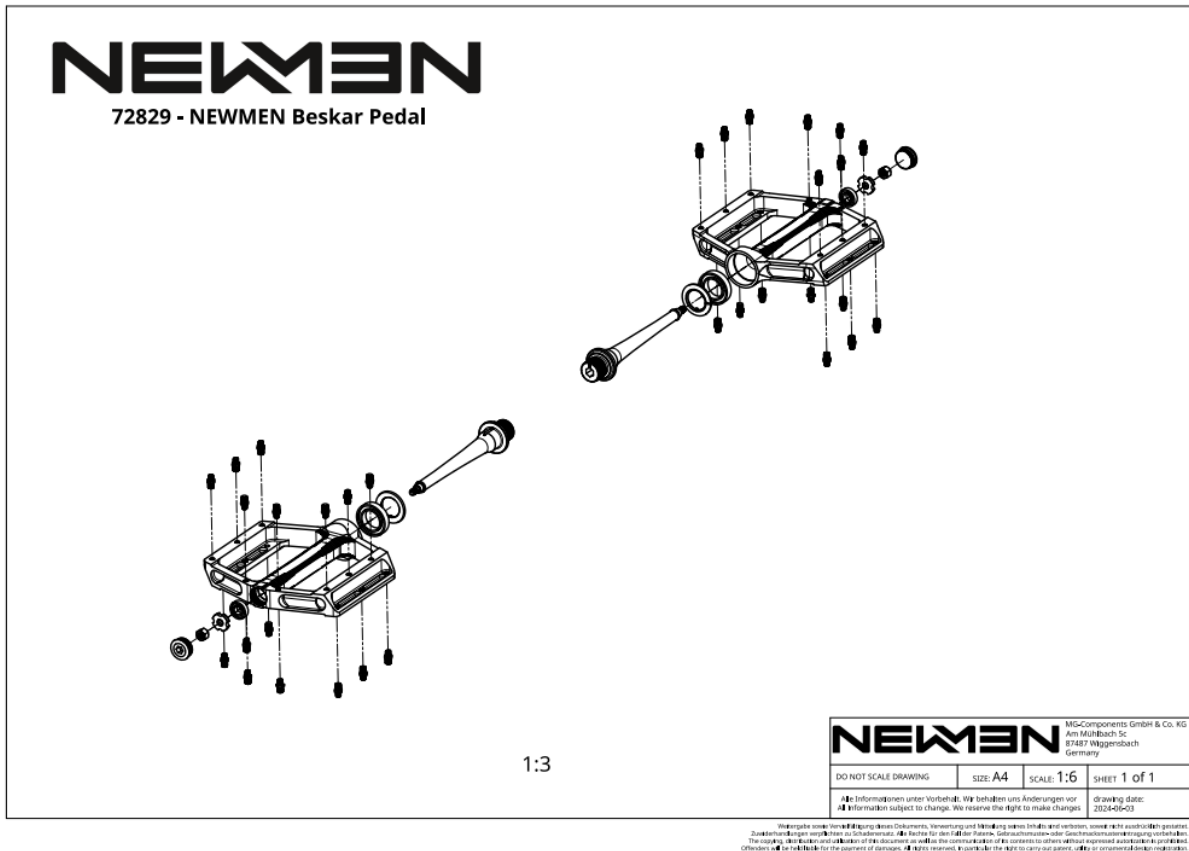

3.1 List of tools

Location used	Tool
Pedal Titanium Axle	6mm Hex key + torque wrench
Pedal Endcap	5mm Hex key torque wrench
Pedal Titanium Axle	Grease gun

3.2 General information

The NEWMEN Beskar Flat Pedal is a lightweight pedal with a Titanium axle. The pedal is filled with grease inside to protect the bearings from corrosion.

3.3 Installation

1. Apply some anti-seize paste to the thread of both pedal axles

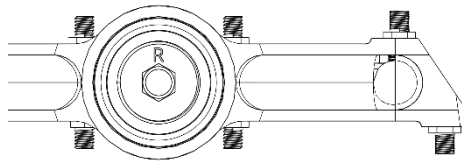

2. Start by installing the right (drive-) side. The letters for the respective side are shown on the inside of the pedal axle.
3. Place the thread of the right pedal axle on the thread of the crank by hand and screw the pedal onto the crank in a clockwise direction.
4. Use a 6mm hex key from the inside of the crank to tighten the pedal axle to 30Nm.

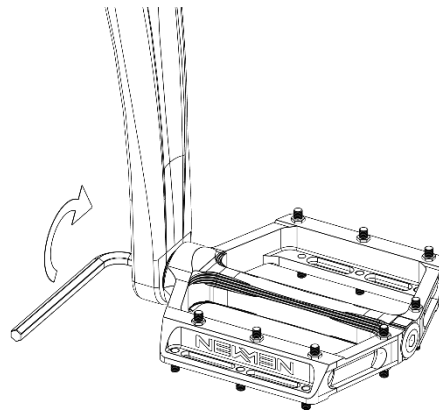

5. Now install the left pedal on the left (brake-) side. The letters for the respective side are shown on the inside of the pedal axle.

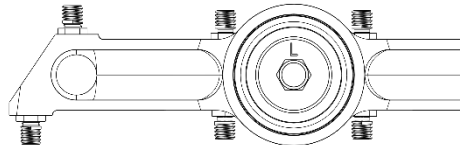

6. The thread of the left pedal axle has a left-hand thread. The pedal must be screwed onto the crank counterclockwise by hand.
7. Use a 6mm hex key from the inside of the crank to tighten the pedal axle to 30Nm.

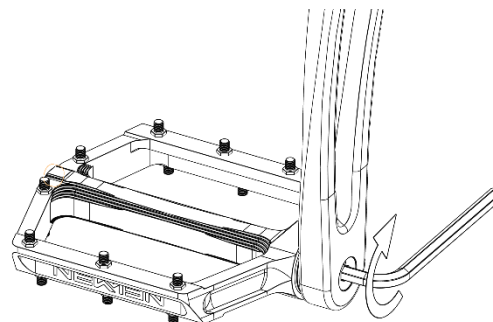

8. Then check that all parts are tight and that there is no play.

4 Maintenance

4.1 Pedal maintenance schedule

NEWMEN Beskar pedals are fully repairable and must be checked and serviced at regular intervals.

- Visual inspection every ride! Inspect the pedals for wear, damage or loose parts
- Regrease pedals after every 30 hours of riding.
- Overhauled every 200 hours of riding.

4.2 Grease NEWMEN pedal

To regrease the pedals, you don't need to disassemble the pedals from the crank. When removing the pedal from the crank, it is easier to clean off the excess grease from the pedal and crank. Greasing the pedals works identically on the left and right side with the following steps:

1. Unscrew the end cap from the pedal with a 5mm hex key.

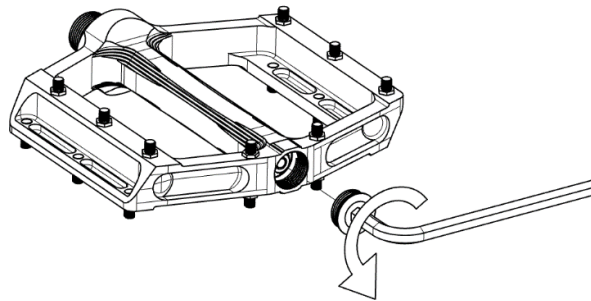

2. Screw the grease adapter onto the pedal by hand.

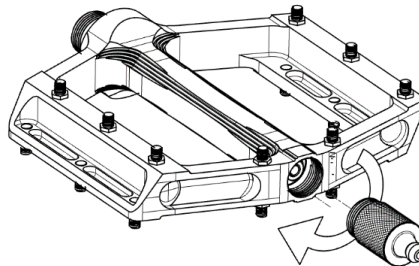

3. Take a grease gun and connect it to the grease nipple. Pump grease into the pedal until grease comes out of the other end of the pedal.

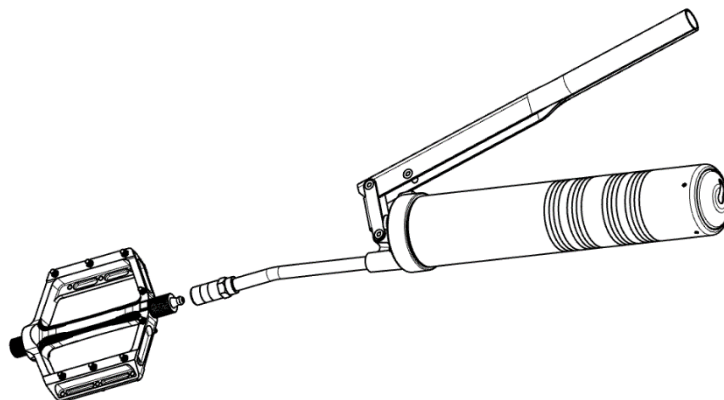

4. The grease gun can then be removed from the grease nipple. Remove excess grease from the pedal and, if necessary, the crank with a rag so that no dirt can adhere here.

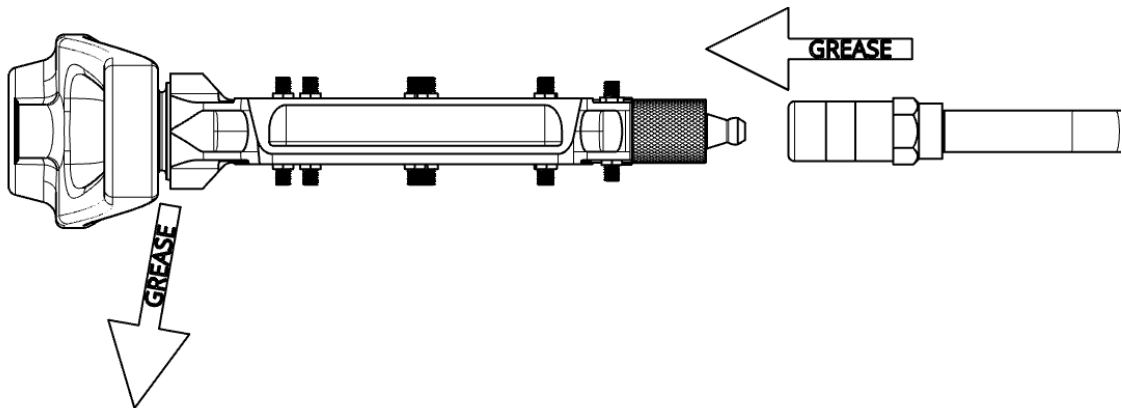

5. Screw the end cap back onto the pedal with 3Nm.

4.3 Service the pedal

The pedal can be easily serviced with the **NEWMEN service kit (item no. 90962)**. The service kit for the NEWMEN Beskar pedal includes the following items:

- zerk grease adapter
- Bearing BB FB 6x13x3,5 CN
- Bearing BB FB 15x24x5 CN LU
- Pedal M4 Nut right thread
- Pedal M4 Nut left thread
- Pedal Spring Washer

Note that the pedal M4 nut must be tightened to a maximum of 1.5 Nm!

The nut for the left-hand side has a right-hand thread, the nut for the right-hand side has a left-hand thread.

For correct service check the service manual on www.newmen-components.de/Downloads

You can also hand the pedals to your preferred bike shop or contact our support team on the NEWMEN website.